

**THE BOROUGH OF FAREHAM  
(OFF-STREET PARKING PLACES) (AMENDMENT 5) ORDER 2022**

Fareham Borough Council in exercise of its powers under Sections 32, 35 and Part IV of Schedule 9 of the Road Traffic Regulation Act 1984 (“the Act”) and of all other enabling powers, with the consent of the Hampshire County Council pursuant to Section 39(3) of the Act and after consultation with the Chief Officer of Police in accordance with Part III of Schedule 9 to the Act, hereby makes the following Order:

**CITATION**

- 1** This Order shall come into operation on XXXXX and may be cited as The Borough of Fareham (Off-Street Parking Places) (Amendment 5) Order 2022.

**INTERPRETATION**

- 2** In this Order:
- (i) “Principal Order” shall mean The Borough of Fareham (Off-Street Parking Places) Consolidation Order 2017 (as amended).
  - (ii) Except where otherwise stated, any reference to an Article or Schedule shall be construed as a reference to that Article or Schedule in this Order.
  - (iii) Any reference to an enactment shall be construed as a reference to that enactment as amended by any subsequent enactments.

**AMENDMENTS**

- 3** Schedule Five of the Principal Order shall be deleted and replaced by the contents of Schedule One to this Order.
- 4** The heading of Schedule Six of the Principal Order shall be deleted and replaced by '24 hour (maximum) car parks (free)'.
- 5** Portchester Precinct Car Park and all its related provisions shall be deleted from Schedule Six of the Principal Order and replaced by the contents of Schedule Two to this Order.
- 6** Holly Hill Car Park, Barnes Lane and all its related provisions shall be deleted from Schedule Six of the Principal Order.
- 7** Hove-to Car Park, Hill Head and all its related provisions shall be deleted from Schedule Six of the Principal Order.

THE COMMON SEAL of  
FAREHAM BOROUGH COUNCIL  
was hereunto affixed this XX day of  
xxxxxxx 2022

in the presence of:

Authorised Signatory

DRAFT

## Schedule One

### **Schedule 5 – Limited wait car parks (free)**

1	2	3	4
Name of Parking Place	Classes of Vehicles	Position in which Vehicle may wait	Maximum Period for which Vehicles may wait
Stubbington Lane Car Park, Stubbington	All Vehicles except a) Goods Vehicles exceeding 1525kg unladen weight; b) Passenger Vehicles adapted to carry more than 12 passengers exclusive of the driver and c) Trailers	Wholly within a bay not reserved for any other class of Vehicle or person.  Motor Cycles may only wait within a bay marked "Motor Cycles Only"	2 hours
Middle Road Car Park, Park Gate	All Vehicles except a) Goods Vehicles exceeding 1525kg unladen weight; b) Passenger Vehicles adapted to carry more than 12 passengers exclusive of the driver and c) Trailers	Wholly within a bay not reserved for any other class of Vehicle or person  Motor Cycles may only wait within a bay marked "Motor Cycles Only"	2 hours, No Return within 4 hours.
The Green Car Park, Stubbington	All Vehicles except a) Goods Vehicles exceeding 1525kg unladen weight; b) Passenger Vehicles adapted to carry more than 12 passengers exclusive of the driver and c) Motor Cycles; and d) Trailers	Wholly within a bay not reserved for any other class of Vehicle or person.	1 hour, No Return within 3 hours.

Car Park Rear of Standen-House, Stubbington	All Vehicles except a) Goods Vehicles exceeding 1525kg unladen weight; b) Passenger Vehicles adapted to carry more than 12 passengers exclusive of the driver and c) Trailers	Wholly within a bay not reserved for any other class of Vehicle or person.  Motor Cycles may only wait within a bay marked "Motor Cycles Only"	1 hour  No Return within 3 hours.
Leisure Centre Park Lane, Fareham	All Vehicles except a) Goods Vehicles exceeding 1525kg unladen weight; and b) Trailers	Wholly within a bay not reserved for any other class of Vehicle or person.  Motor Cycles may only wait within a bay marked "Motor Cycles Only" and coaches may only wait in "Coaches Only Zone"	3 hours every day including Bank Holidays and Sundays.  Coaches only Zone to apply 9am to 6pm
Broadcut, Wallington	All Vehicles except a) Goods Vehicles exceeding 1525kg unladen weight; b) Passenger Vehicles adapted to carry more than 12 passengers exclusive of the driver; and c) Trailers	Wholly within a bay not reserved for any other class of Vehicle or person.  Motor Cycles may only wait within a bay marked "Motor Cycles only"	3 hours Monday to Friday  No return within 5 hours.
Leigh Road Car Park	All Vehicles except a) Goods Vehicles exceeding 1525kg unladen weight; b) Passenger Vehicles adapted to carry more than 12 passengers exclusive of the driver; c) Motor Cycles; and d) Trailers	Wholly within a bay not reserved for any other class of Vehicle or person	4 hours

Highlands Road, Shopping Area Car Park	All Vehicles except a) Goods Vehicles exceeding 1525kg unladen weight; b) Passenger Vehicles adapted to carry more than 12 passengers exclusive of the driver; c) Motor Cycles; and d) Trailers	In a position not causing obstruction to any access exit or internal circulating route for Vehicles	Southeast side of service road - 2 hours 8am-7pm Monday to Saturday  Northwest side of service road - 4 hours 8am-7pm Monday to Saturday
Barry's Meadow Car Park	All Vehicles except a) Goods Vehicles exceeding 1525kg unladen weight; b) Passenger Vehicles adapted to carry more than 12 passengers exclusive of the driver; and c) Trailers	Wholly within a bay not reserved for any other class of Vehicle or person.  Motor Cycles may only wait within a bay marked "Motor Cycles Only".	3 Hours
Bishopsfield Road Car Park	All Vehicles except a) Goods Vehicles exceeding 1525kg unladen weight; b) Passenger Vehicles adapted to carry more than eight (8) passengers exclusive of the driver; and c) Trailers	Wholly within a bay not reserved for any other class of Vehicle or person.  Motor Cycles may only wait within a bay marked "Motor Cycles Only".	3 hours between 0800 and 1800 hours on any day and up to 14 hours outside of those hours
Fareham North West Community Centre Car Park	All Vehicles except a) Goods Vehicles exceeding 1525kg unladen weight; b) Passenger Vehicles adapted to carry more than 12 passengers exclusive of the driver; c) Trailers; and d) Motor Cycles	Wholly within a bay not reserved for any other class of Vehicle or person	20 minutes between 0800 and 1800 hours with no return within 2 hours on Mondays to Fridays inclusive  No maximum waiting period on Saturdays and Sundays and recognised Bank Holidays

Burridge Village Hall Car Park (Main)	All Vehicles except a) Goods Vehicles exceeding 1525kg unladen weight; b) Passenger Vehicles adapted to carry more than 12 passengers exclusive of the driver; c) Motor Cycles; and d) Trailers	Wholly within a bay not reserved for any other class of Vehicle or person	2 hours, No Return within 2 hours.  Official Permit Holders may wait for a period not exceeding 24 hours
Warsash Road Car Park Warsash	All Vehicles except a) Goods Vehicles exceeding 1525kg unladen weight; b) Passenger Vehicles adapted to carry more than 12 passengers exclusive of the driver and c) Trailers.	Wholly within a bay not reserved for any other class of Vehicle or person.  Motor Cycles may only wait within a bay marked "Motor Cycles Only".	4 Hours  No return within 4 hours
Holly Hill Car Park, Barnes Lane	All Vehicles except a) Goods Vehicles exceeding 1525kg unladen weight; b) Motor Cycles and c) Passenger Vehicles adapted to carry more than 12 passengers exclusive of the driver; and d) Trailers	Wholly within a bay not reserved for any other class of Vehicle or person.	4 Hours  No return within 4 hours
Barnes Close, Sarisbury	All Vehicles except a) Goods Vehicles exceeding 1525kg unladen weight; b) Motor Cycles and c) Passenger Vehicles adapted to carry more than 12 passengers exclusive of the driver; and d) Trailers	Wholly within a bay not reserved for any other class of Vehicle or person.	4 Hours  No return within 4 hours

Broadcut Retail Park, Wallington	All Vehicles except a) Goods Vehicles exceeding 1525kg unladen weight; b) Motor Cycles; c) Passenger Vehicles adapted to carry more than 12 passengers exclusive of the driver and d) Trailers.	Wholly within a bay not reserved for any other class of Vehicle or person.	3 Hours No return within 5 hours
Cams Alders Car Park	All Vehicles except a) Goods Vehicles exceeding 1525kg unladen weight; b) Motor Cycles; c) Passenger Vehicles adapted to carry more than 12 passengers exclusive of the driver; and d) Trailers.	Wholly within a bay not reserved for any other class of Vehicle or person.	4 Hours No return within 4 hours

## Schedule Two

Portchester Precinct Car Park	All Vehicles	<p>Wholly within a bay not reserved for any other class of Vehicle or person.</p> <p>Motor Cycles may only wait within a bay marked "Motor Cycles Only".</p>	<p>24 hours every day including Sundays and recognised Public Holidays except for the parking areas shown as "3 Hour Parking" on the plan attached hereto, which shall be 3 hours every day including Sundays and recognised Public Holidays</p>
-------------------------------	--------------	--	--





# FAREHAM BOROUGH COUNCIL

PO BOX 82 CIVIC OFFICES CIVIC WAY FAREHAM PO16 7TT

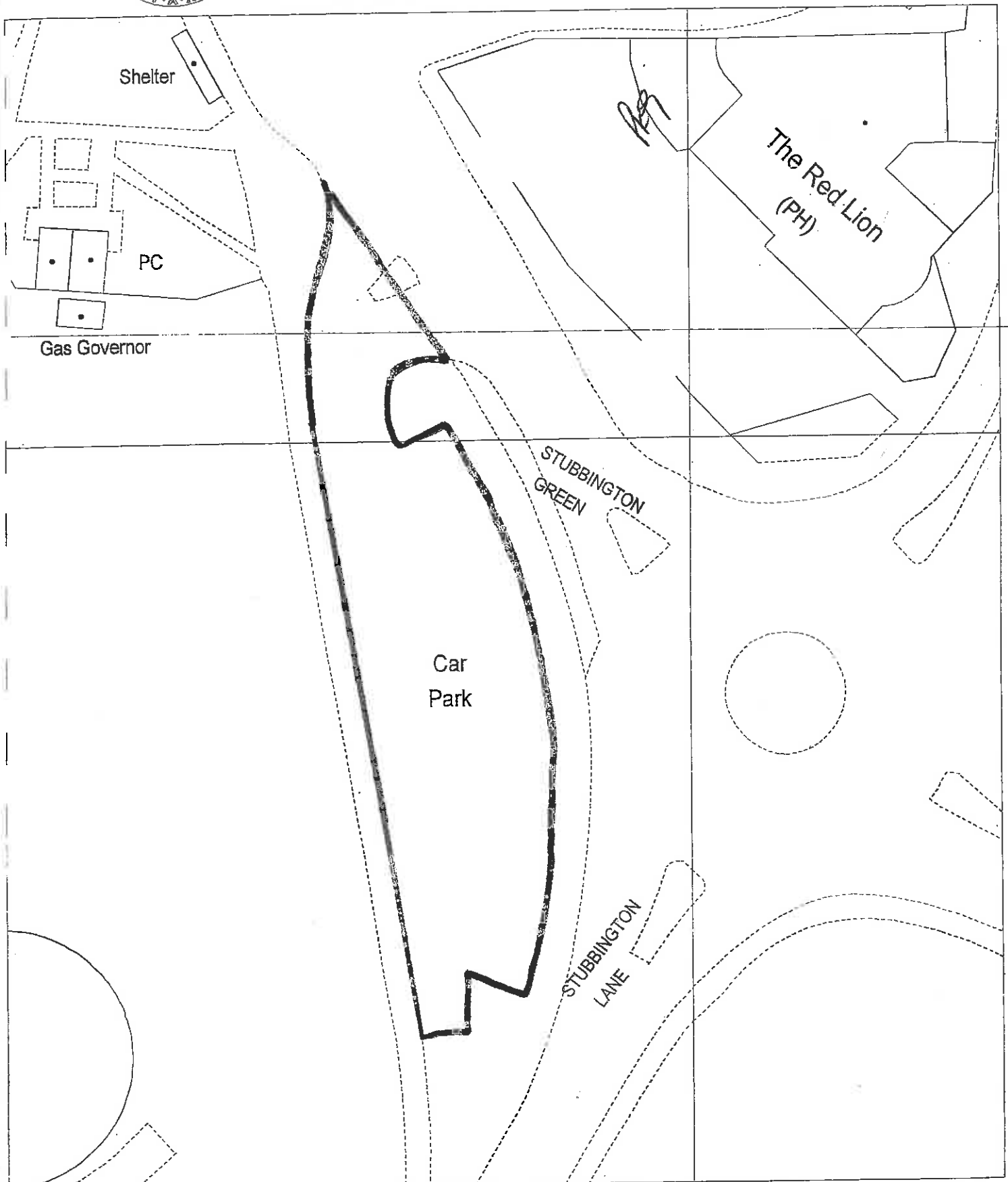

Stubbington Lane Car Park,  
Stubbington.

Dwg. No.	E/1608	APPENDIX A
Date	26th February 2001	Scale 1:500

Reproduced from the Ordnance Survey Landline Data with the permission of Her Majesty's Stationery Office. © Crown Copyright. Unauthorised reproduction breaks Crown copyright and may lead to prosecution or civil proceedings.





# FAREHAM BOROUGH COUNCIL

PO BOX 82 CIVIC OFFICES CIVIC WAY FAREHAM PO16 7TT

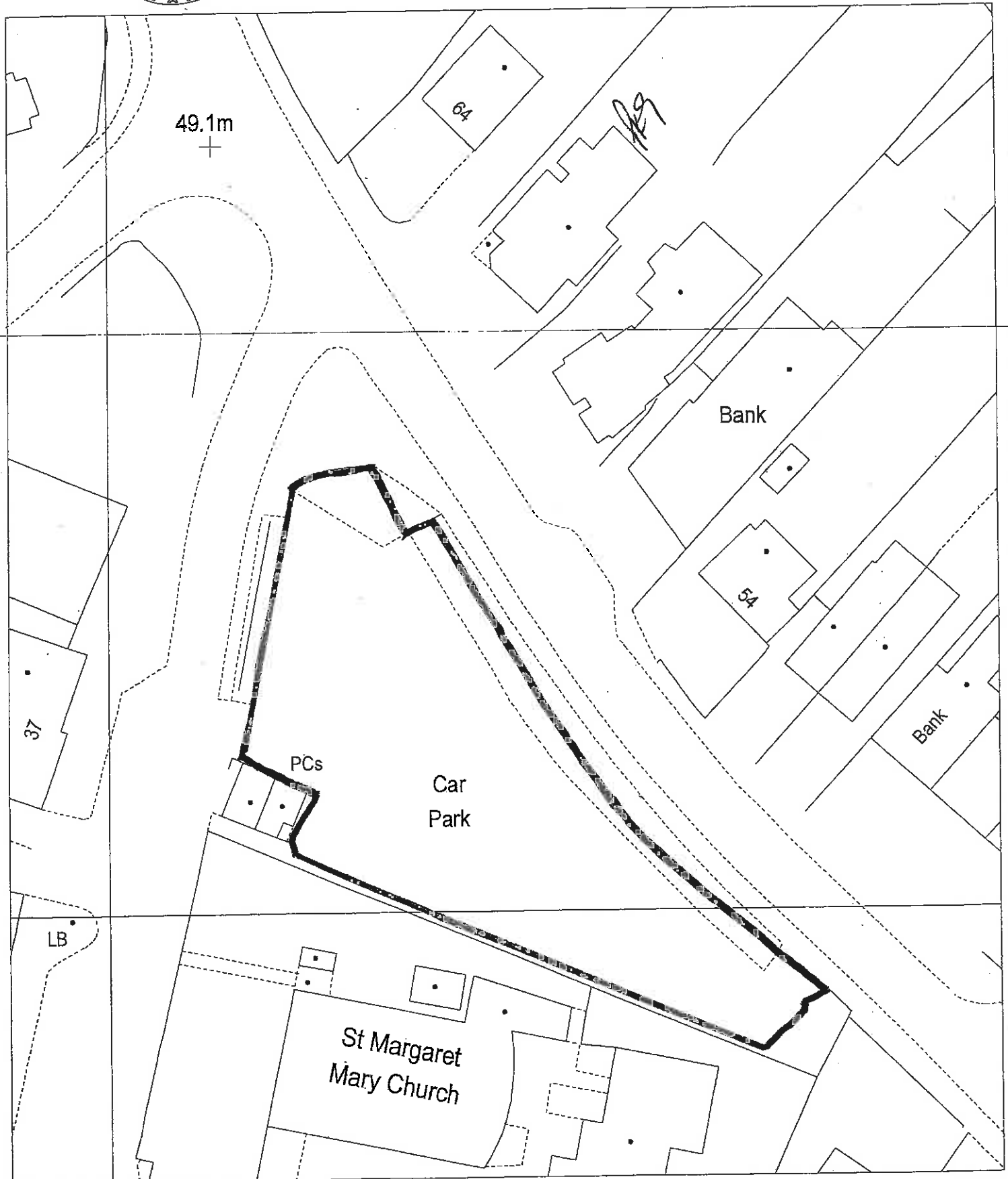

Middle Road Car Park, Park Gate

Dwg. No. **E/1615**

APPENDIX A

Date 15th February 2001

Scale 1:500

Reproduced from the Ordnance Survey Landline Data with the permission of Her Majesty's Stationery Office. © Crown Copyright. Unauthorised reproduction breaks Crown copyright and may lead to prosecution or civil proceedings. Fareham Borough Council LA 077978





# FAREHAM BOROUGH COUNCIL

PO BOX 82 CIVIC OFFICES CIVIC WAY FAREHAM PO16 7TT

Sub Sta

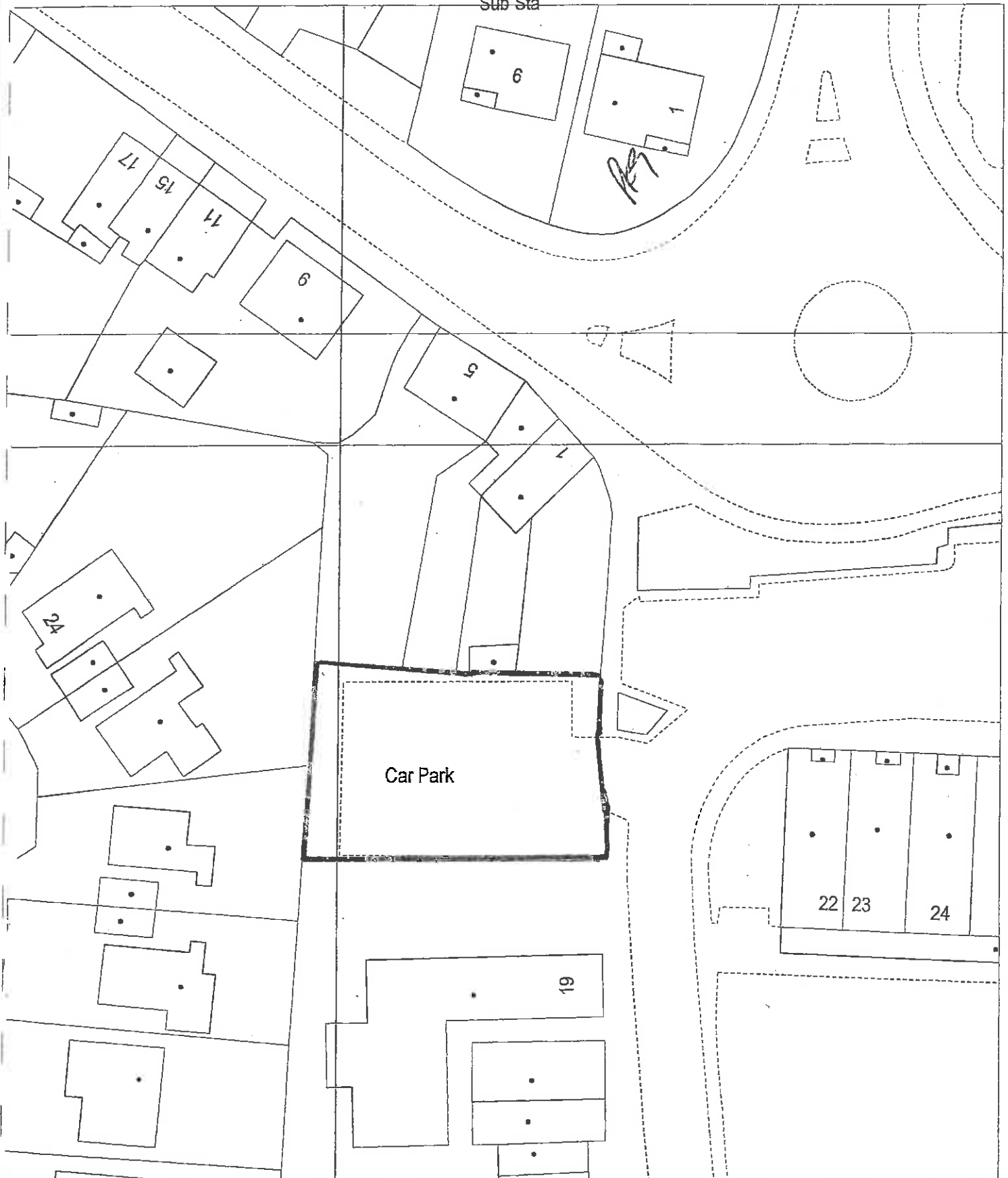

The Green Car Park, Stubbington

Dwg. No. **E/1612**

APPENDIX A

Date 13th February 2001

Scale 1:500

Reproduced from the Ordnance Survey Landline Data with the permission of Her Majesty's Stationery Office. © Crown Copyright  
Unauthorized reproduction breaks Crown copyright  
and may lead to prosecution or civil proceedings  
Fareham Borough Council LA 07/2006





# FAREHAM BOROUGH COUNCIL

PO BOX 82. CIVIC OFFICES CIVIC WAY FAREHAM PO16 7TT

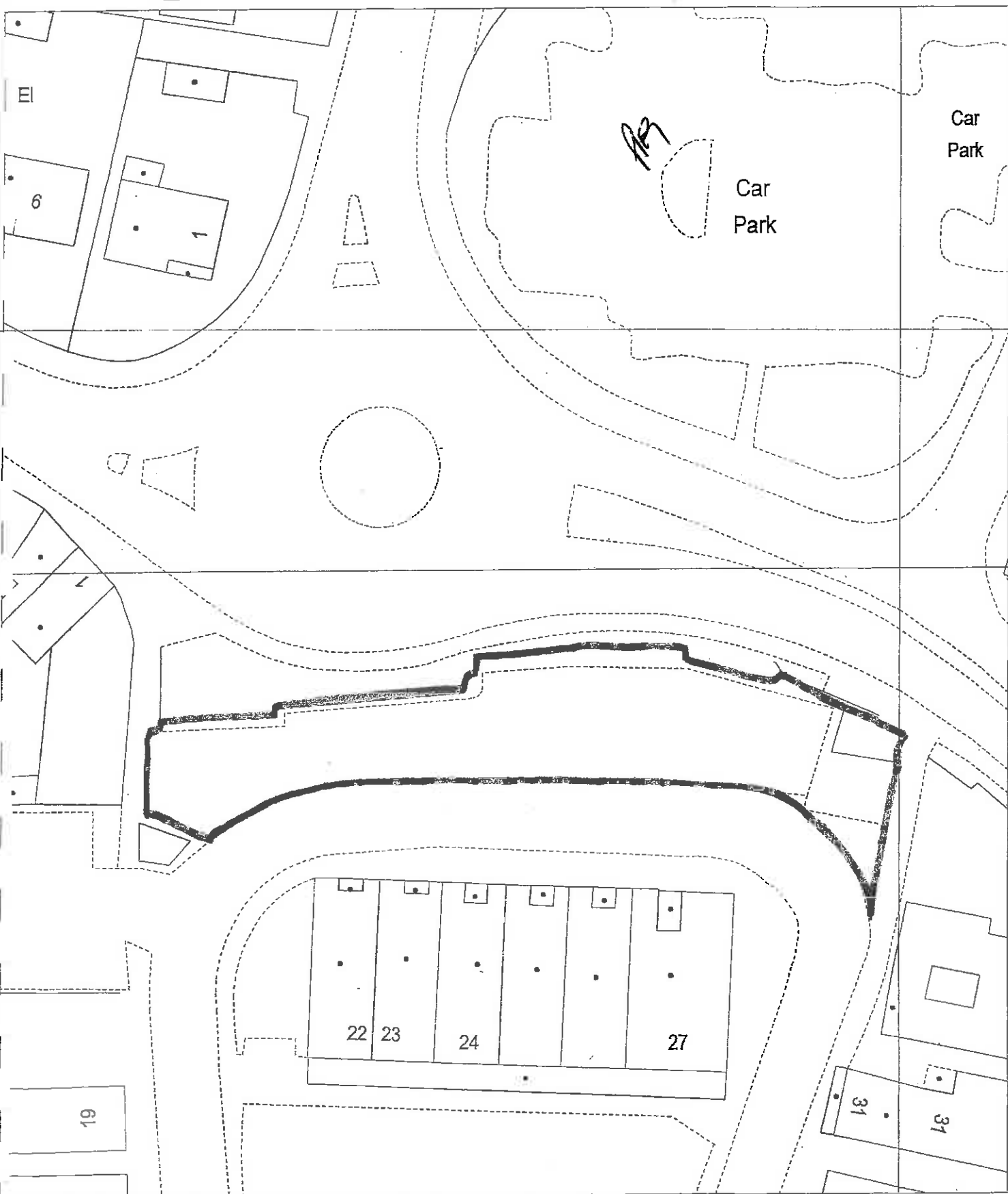

Car Park Rear of Standen-House,  
Stubbington

Dwg. No.	<b>E/1613</b>	APPENDIX A
Date	26th February 2001	Scale 1:500
<small>Reproduced from the Ordnance Survey Landline Data with the permission of Her Majesty's Stationery Office. © Crown Copyright. Unauthorised reproduction breaks Crown copyright and may lead to prosecution or civil proceedings. Ordnance Survey Licence 14 0000000000</small>		



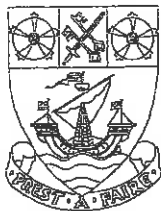

# FAREHAM BOROUGH COUNCIL

PO BOX 82 CIVIC OFFICES CIVIC WAY FAREHAM PO16 7TT



Leisure Centre Car Park, Fareham

Dwg. No. **E/1621**

APPENDIX A

Date 14th February 2001

Scale 1:1250

Reproduced from the Ordnance Survey Landline Data with the permission of Her Majesty's Stationery Office. © Crown Copyright. Unauthorised reproduction breaks Crown copyright and may lead to prosecution or civil proceedings. Fareham Borough Council 1 & 197977R





# FAREHAM BOROUGH COUNCIL

PO BOX 82 CIVIC OFFICES CIVIC WAY FAREHAM PO16 7TT

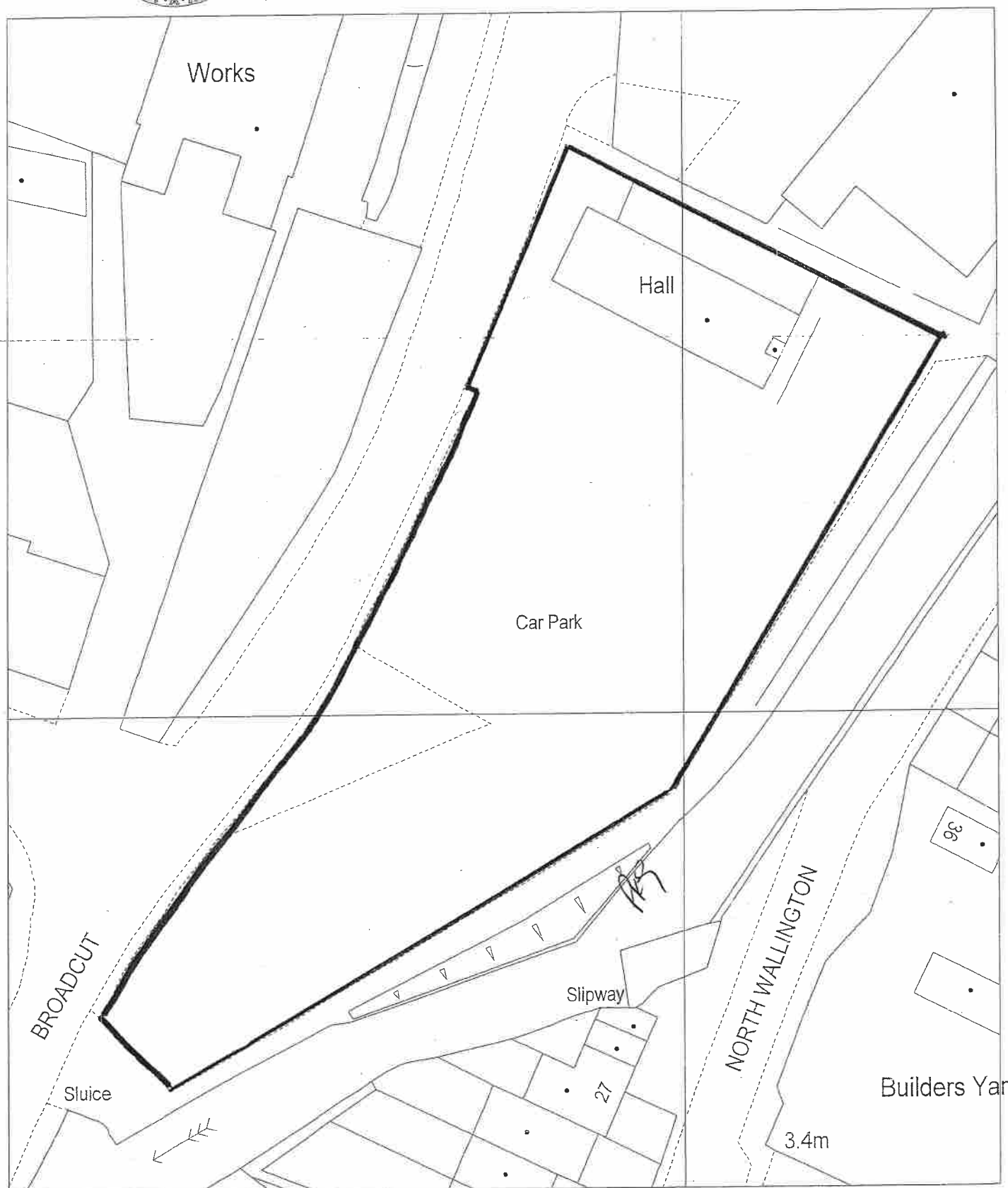

Broadcut, Wallington

Dwg. No. **E/1636**

APPENDIX A

Date 23rd January 2001

Scale-

Reproduced from the Ordnance Survey Landuse Data with the permission of Her Majesty's Stationery Office. © Crown Copyright. Unauthorized reproduction breaks Crown copyright and may lead to prosecution or civil proceedings. Fareham Borough Council: LA 077976



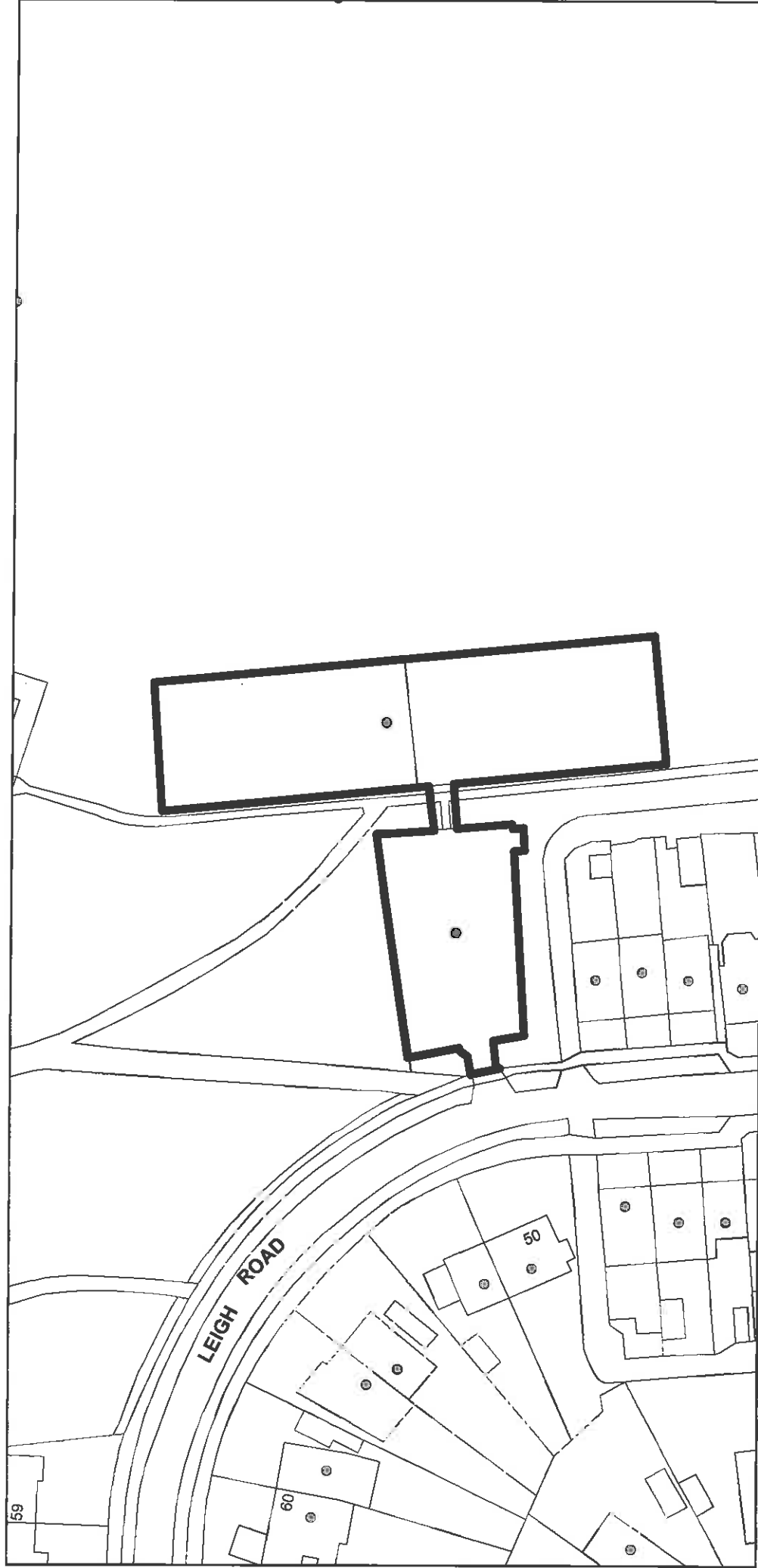

Drawing No. E/1595

APPENDIX A

Date: 16th June 2017

Scale: 1:500

## Leigh Road Car Park

This map is reproduced from Ordnance Survey material with the permission of Ordnance Survey on behalf of the Controller of Her Majesty's Stationary Office © Crown Copyright. Unauthorised reproduction infringes Crown Copyright and may lead to prosecution or civil proceedings. Licence 100019110. 2013



# FAREHAM BOROUGH COUNCIL

PO BOX 82 CIVIC OFFICES CIVIC WAY FAREHAM PO16 7TT

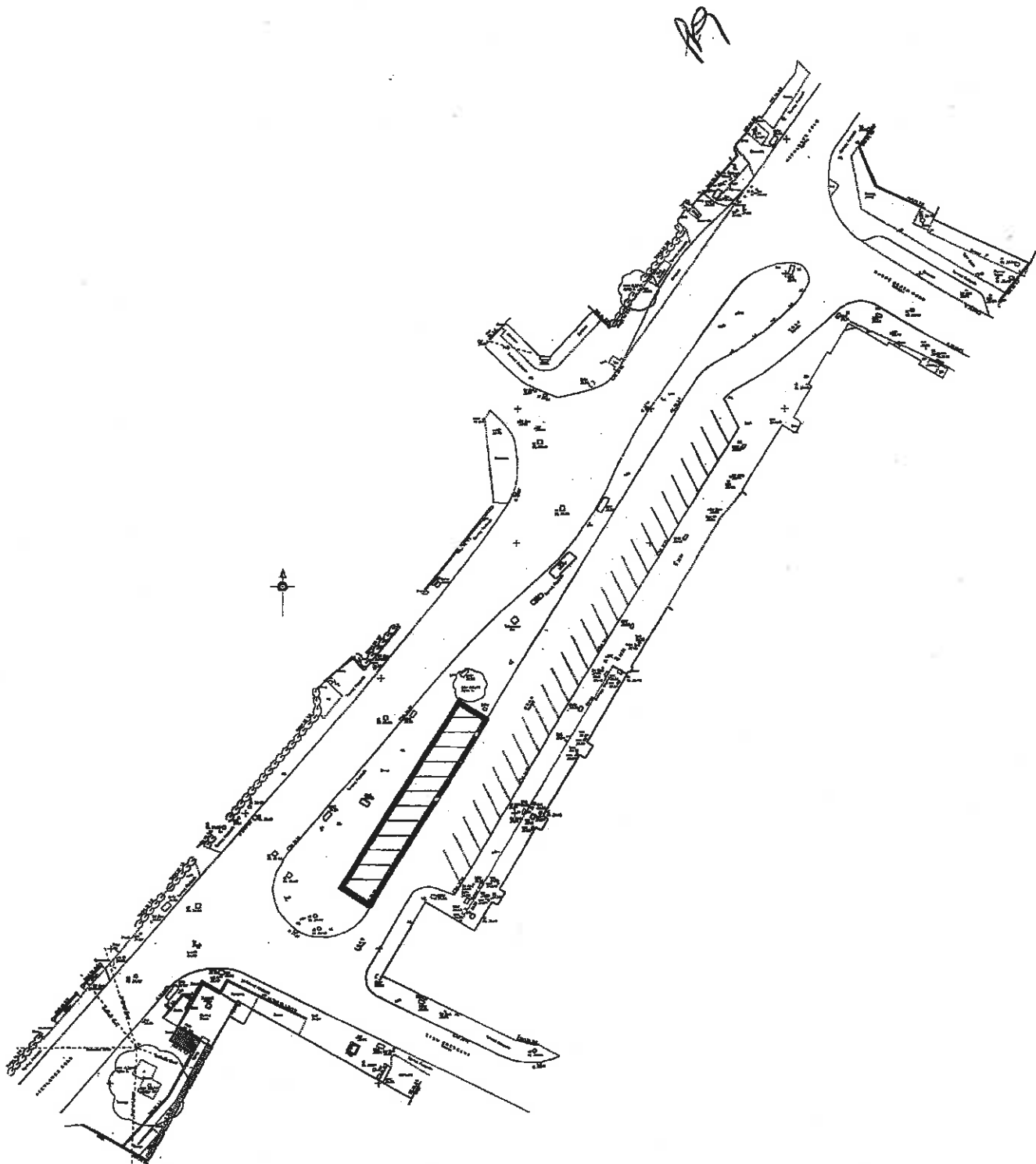

Highlands Road, Shopping Area Car Park

Dwg. No. <b>E/1616</b>	APPENDIX A
Date 13th February 2001	Scale 1:500

Reproduced from the Ordnance Survey Landline Data with the permission of Her Majesty's Stationary Office. © Crown Copyright  
Unauthorized reproduction breaks Crown copyright  
and may lead to prosecution or civil proceedings  
Fareham Borough Council LA 077978







# FAREHAM BOROUGH COUNCIL

PO BOX 82 CIVIC OFFICES CIVIC WAY FAREHAM PO16 7TT

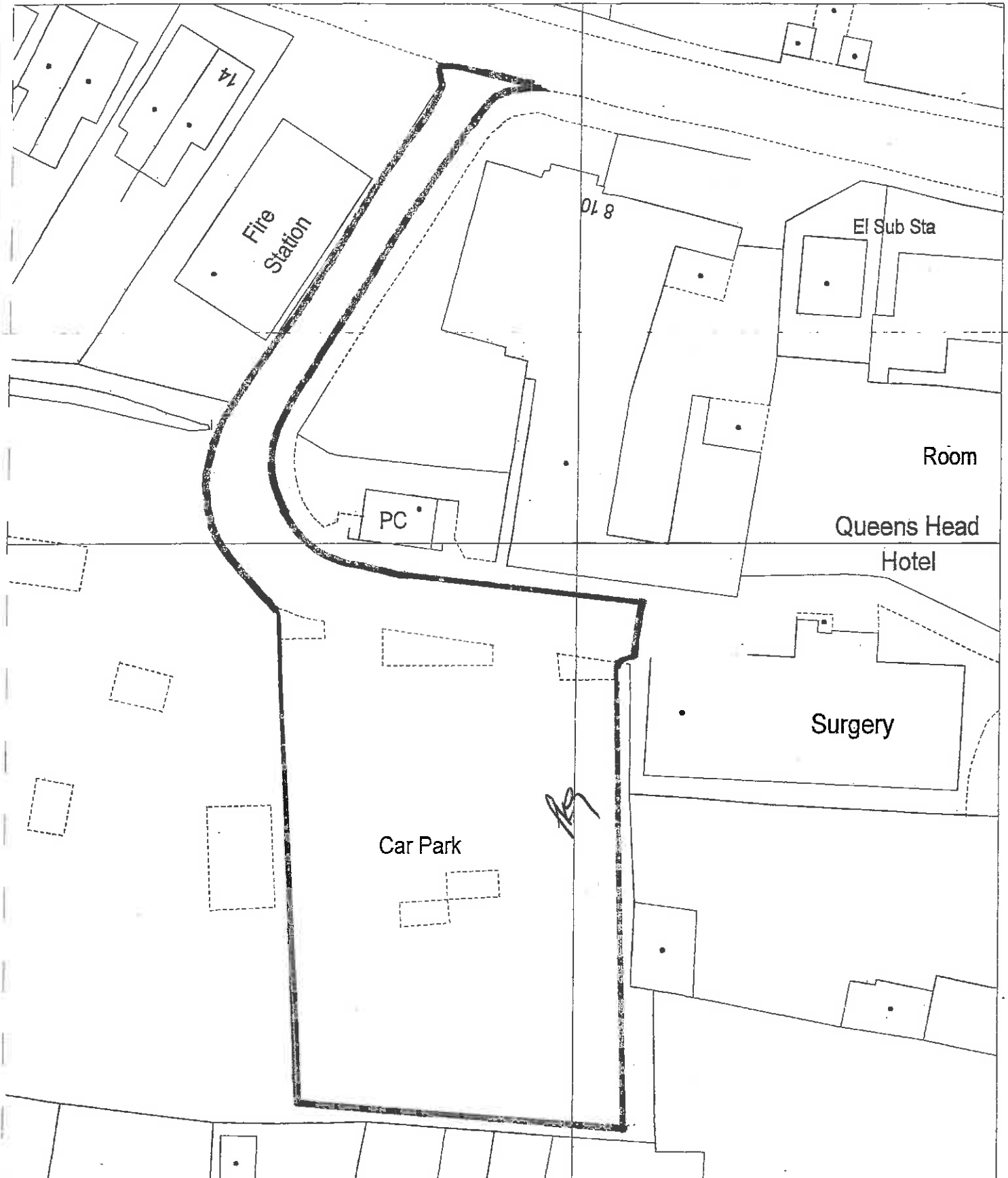

Barry's Meadow Car Park

Dwg. No. **E/1620**

APPENDIX A

Date 23rd January 2001

Scale 1:500

Reproduced from the Ordnance Survey Landline Data with the permission of Her Majesty's Stationery Office. © Crown Copyright. Unauthorized reproduction breaks Crown copyright and may lead to prosecution or civil proceedings.  
Fareham Borough Council LA 077976





# FAREHAM BOROUGH COUNCIL

PO BOX 82 CIVIC OFFICES CIVIC WAY FAREHAM PO16 7TY

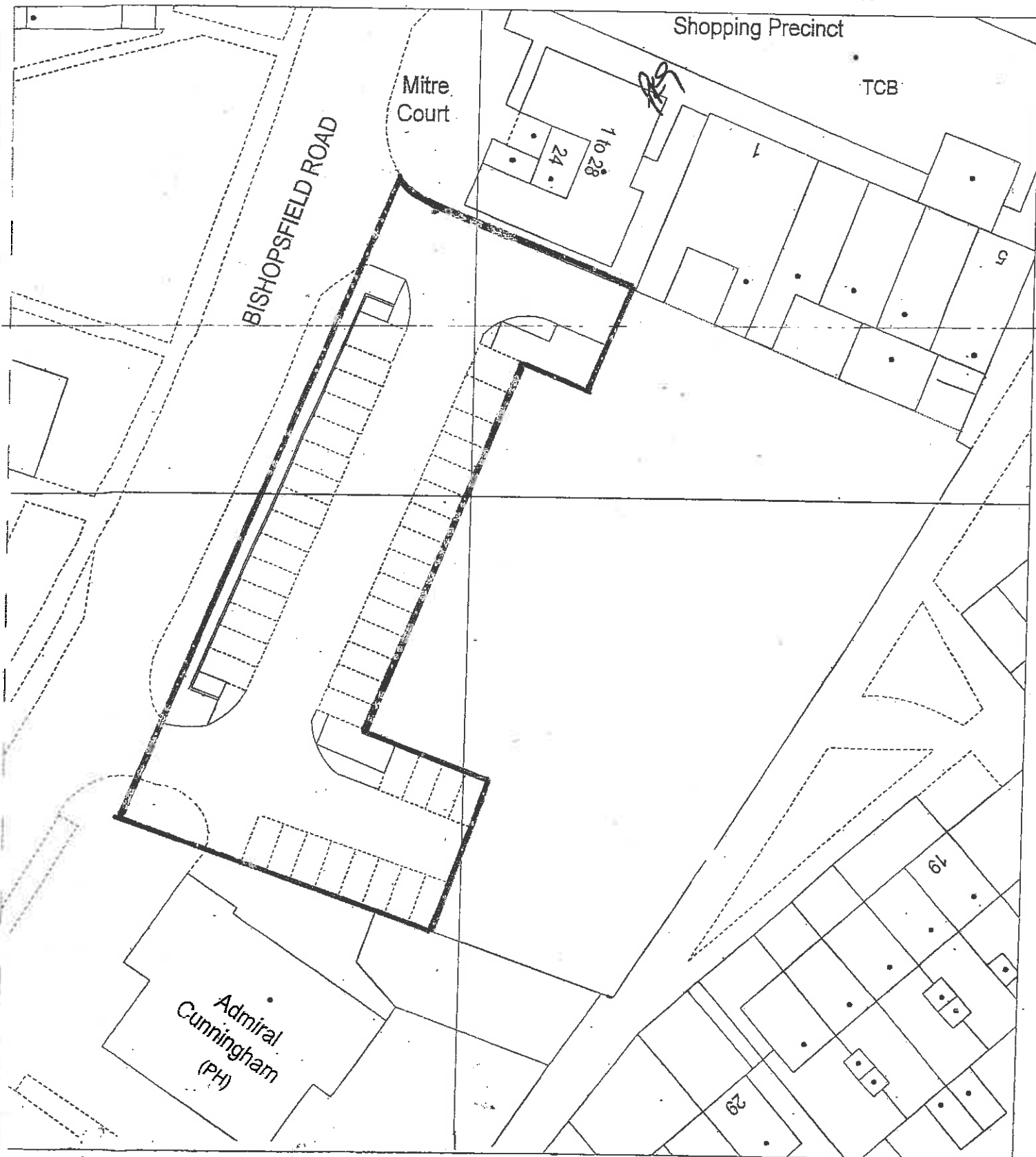

## Bishopsfield Road Car Park

Rev	Amendment	By	Chkd.	Date	Appd.	Drawn By	Date	Checked By	Date	Approved By	Date
						Harun Miah	06/03/03	Sandra Hill	06/03/03		
						Drawing No. <b>ET/0074/1/A</b>					
						Scale	Reproduced from the Ordnance Survey Landline Data with the permission of Her Majesty's Stationary Office. © Crown Copyright.				Rev.





# FAREHAM BOROUGH COUNCIL

PO BOX 82 CIVIC OFFICES CIVIC WAY FAREHAM PO16 7TY

Fareham Park  
Farm Cottages

2

Community Centre

Disabled parking bay

Proposed area of order  
within dashed line

Henry Cort Drive

39.0m

School car park

## Fareham North West Community Centre car park Order

Rev.	Amendment	By	Chkd.	Date	Appd.	Drawn By	Date	Checked By	Date	Approved By	Date

Drawing No.	0002	APPENDIX A
Scale	1:500	Rev. A
<small>Reproduced from the Ordnance Survey Landline Database Inc. reproduction of Her Majesty's Stationery Office. © Crown Copyright. Unauthorised reproduction is prohibited. Any use of this copyright material may lead to prosecution or civil proceedings. Fareham Borough Council LA 077016</small>		



# FAREHAM

## BOROUGH COUNCIL

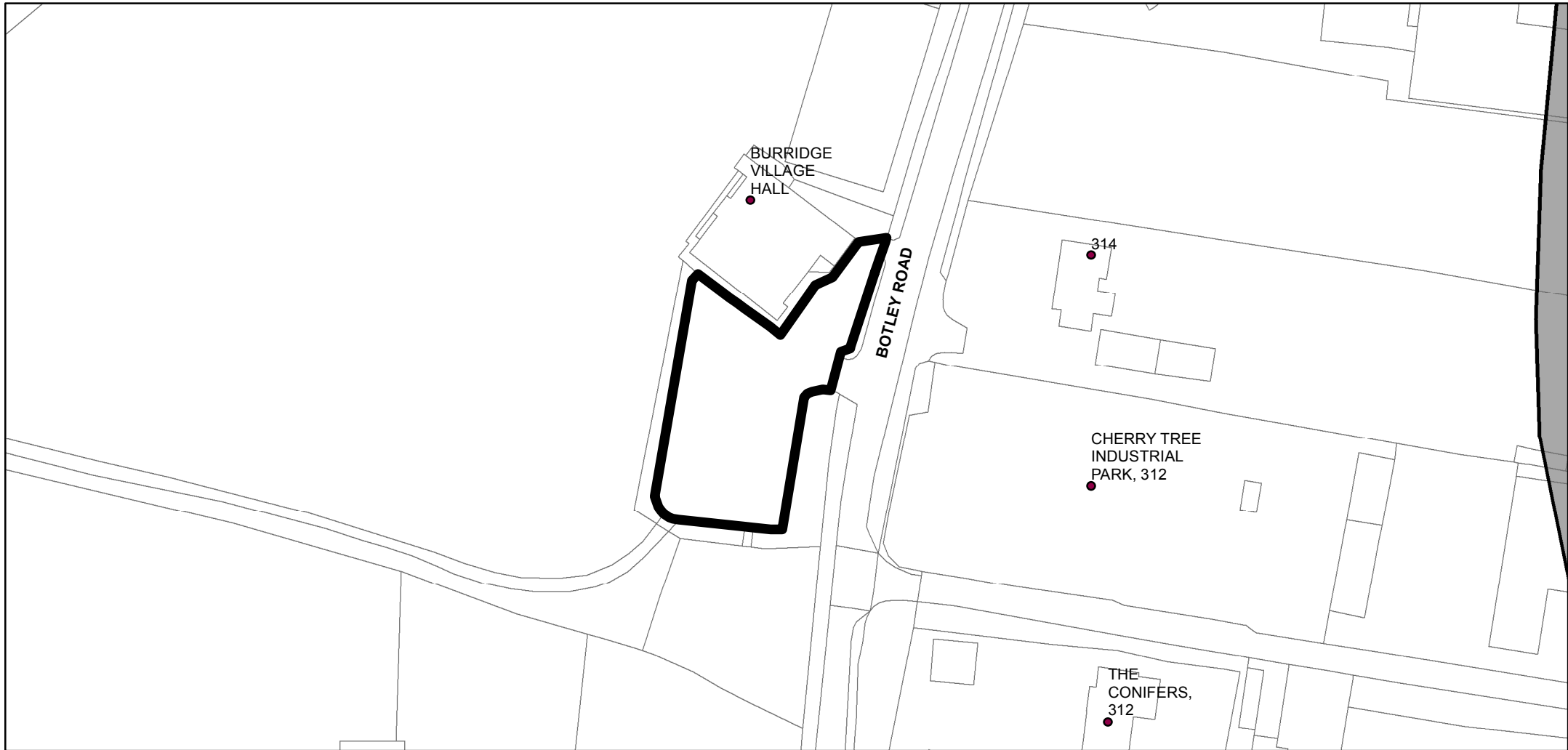

## Burridge Village Hall Car Park

Drawing No.

APPENDIX A

Date: 24th May 2018

Scale: 1:1,000

© Crown copyright and database rights 2018 Ordnance Survey 100019110. You are permitted to use this data solely to enable you to respond to, or interact with, the organisation that provided you with the data. You are not permitted to copy, sub-licence, distribute or sell any of this data to third parties in any form.



# FAREHAM BOROUGH COUNCIL

PO BOX 82 CIVIC OFFICES CIVIC WAY FAREHAM PO16 7TT

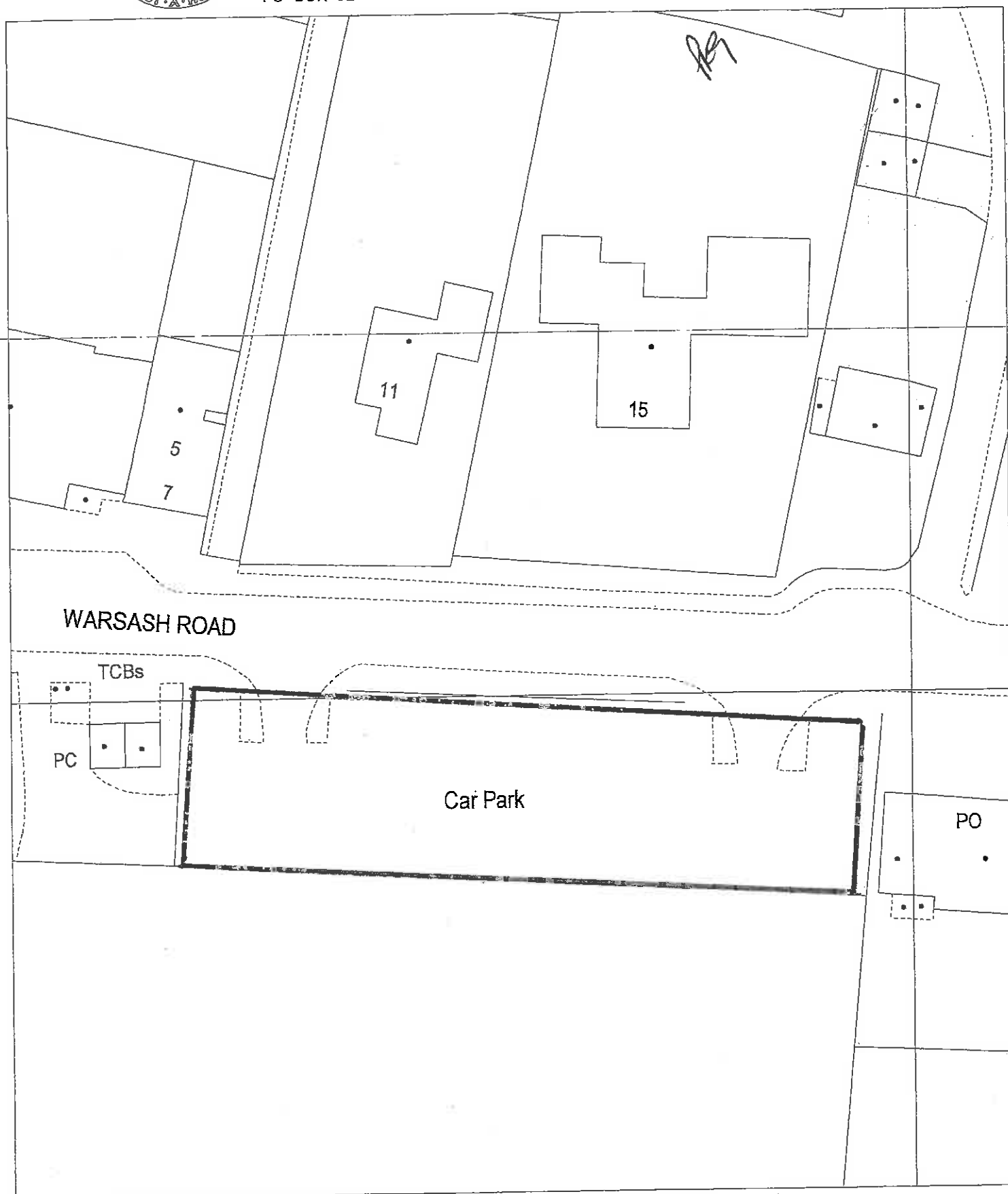

Warsash Road Car Park, Warsash

Dwg. No.	<b>E/1626</b>	APPENDIX A
Date	26th February 2001	Scale 1:500

Reproduced from the Ordnance Survey Landline Data with the permission of Her Majesty's Stationery Office. © Crown Copyright. Unauthorised reproduction breaks Crown copyright and may lead to prosecution or civil proceedings.





# FAREHAM BOROUGH COUNCIL

PO BOX 82 CIVIC OFFICES CIVIC WAY FAREHAM PO16 7TT

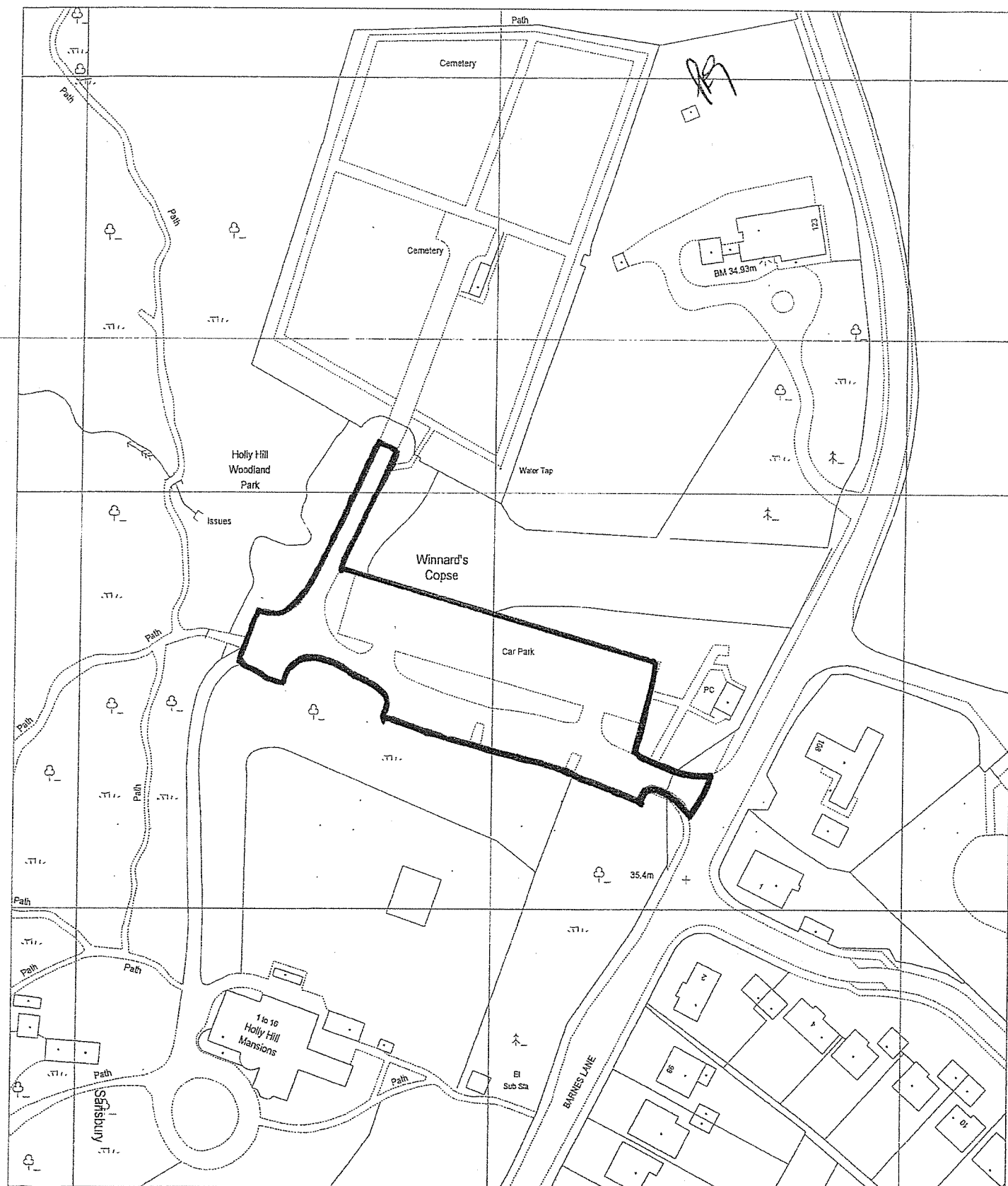

Holly Hill Car Park, Barnes Lane

Dwg. No. **E/1625**

APPENDIX A

Date 14th February 2001

Scale 1:1250

Reproduced from the Ordnance Survey Landline Data with the permission of Her Majesty's Stationary Office. © Crown Copyright  
Unauthorised reproduction breaks Crown copyright  
and may lead to prosecution or civil proceedings  
Fareham Borough Council LA 077976



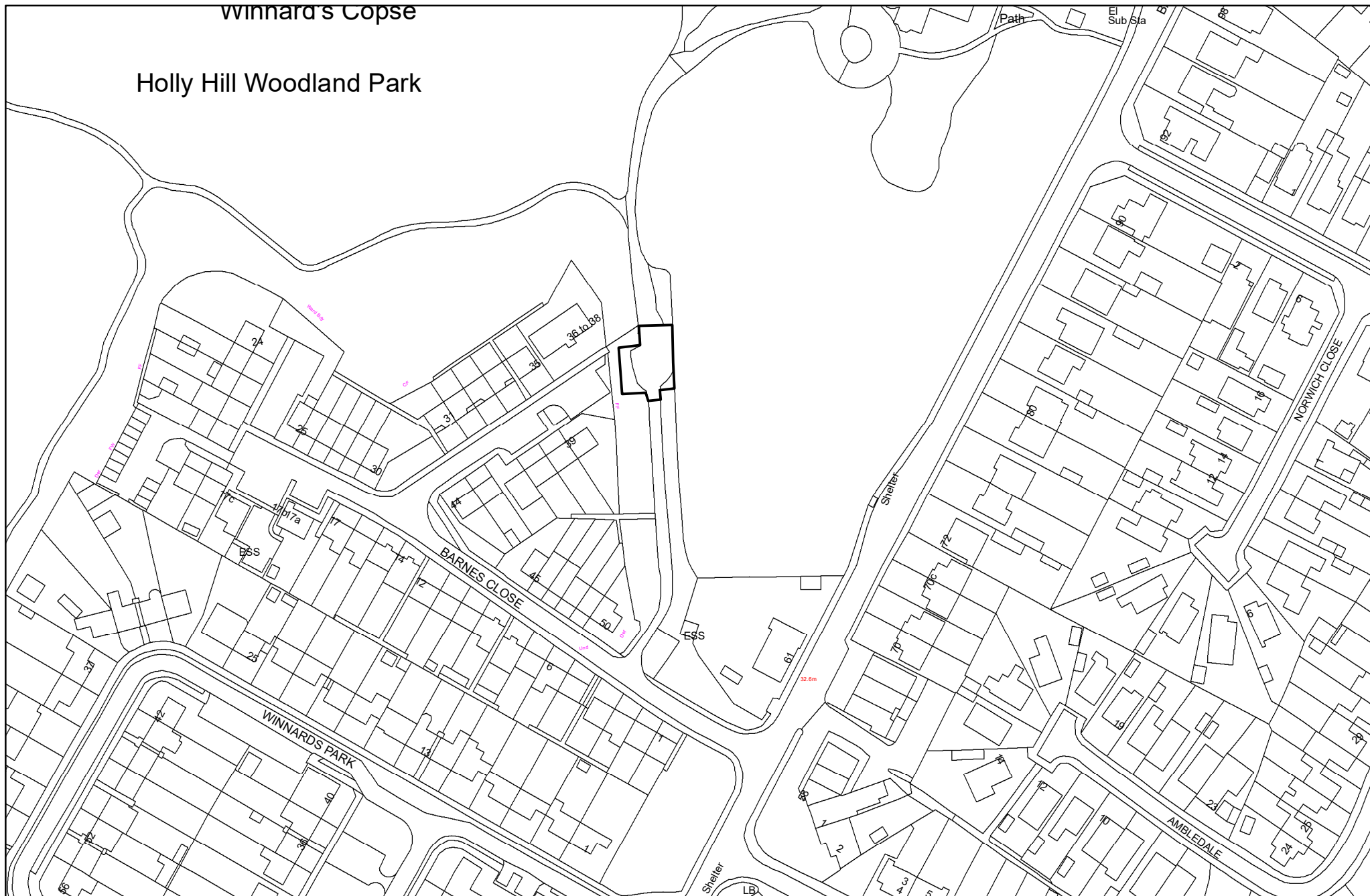

Barnes Close Car Park  
Scale 1:1250

© Crown copyright and database rights 2019 Ordnance Survey 100019110. You are permitted to use this data solely to enable you to respond to, or interact with, the organisation that provided you with the data. You are not permitted to copy, sub-licence, distribute or sell any of this data to third parties in any form.

**FAREHAM**  
BOROUGH COUNCIL

# Broadcut Retail Park Car Park

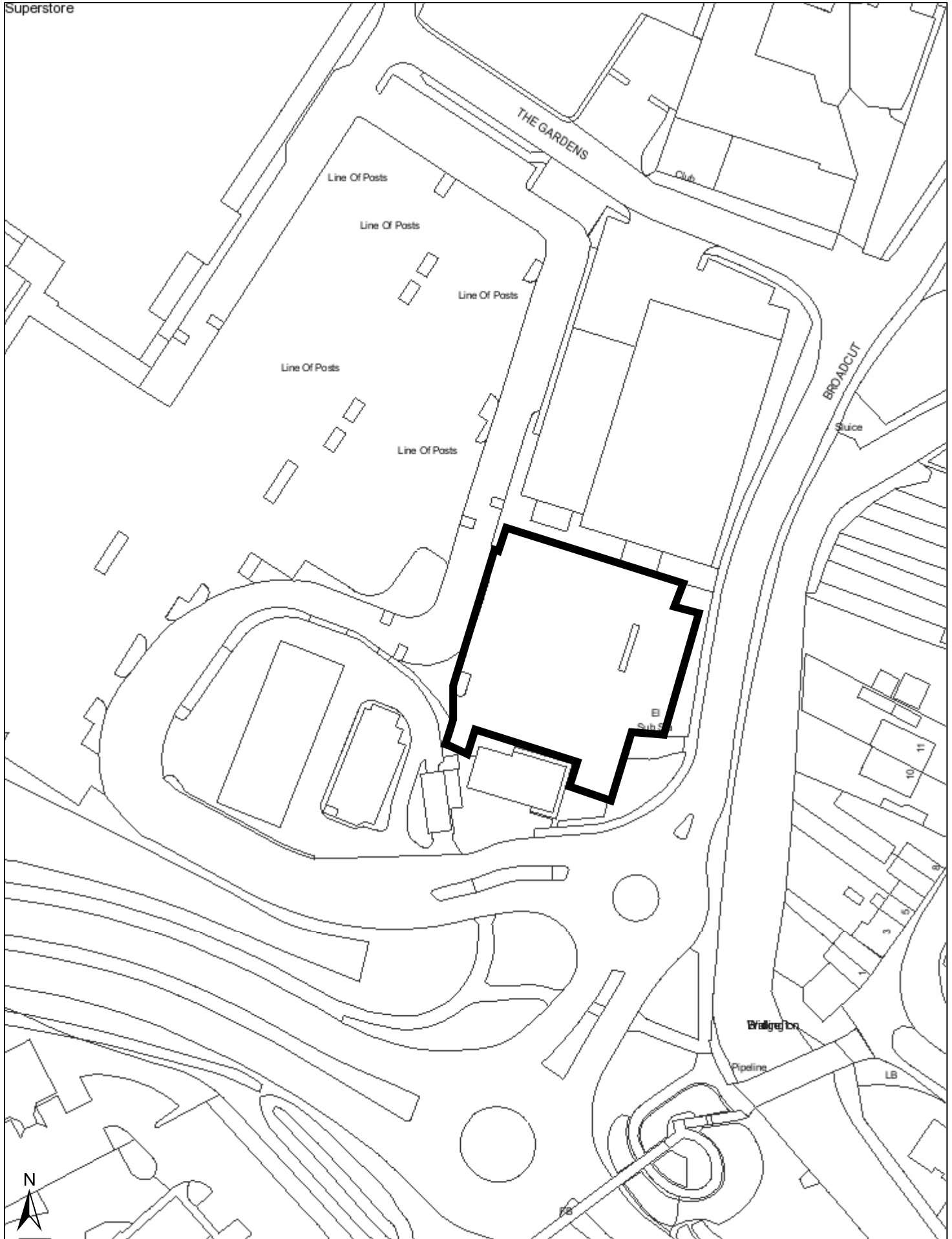



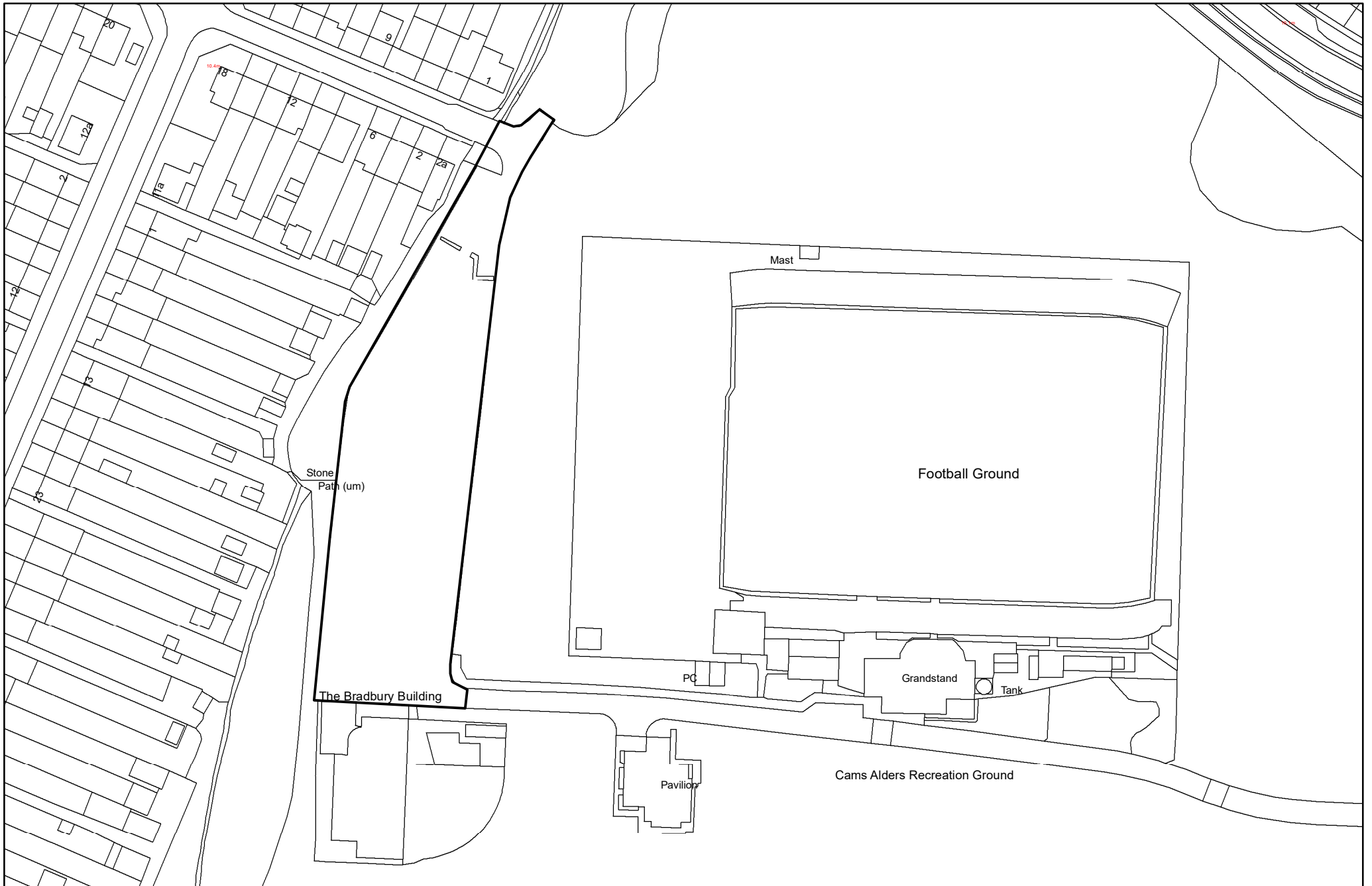

Cams Alders Car park  
Scale 1:1250

© Crown copyright and database rights 2019 Ordnance Survey 100019110. You are permitted to use this data solely to enable you to respond to, or interact with, the organisation that provided you with the data. You are not permitted to copy, sub-licence, distribute or sell any of this data to third parties in any form.

**FAREHAM**  
BOROUGH COUNCIL

# Portchester Precinct Car Park

